

- GENERAL NOTES
- OUR SPECIFICATIONS DATED JANUARY 1983 APPLY TO THIS PROJECT.
 - THE WORKING WIDTH AVAILABLE TO THE CONTRACTOR TO CONSTRUCT THE NEW DRAINS SHALL CONSIST OF THOSE LANDS IMMEDIATELY ADJACENT TO THE DRAIN AND CONNECTIONS AND SHALL NOT EXCEED AN AVERAGE WIDTH OF 20 METERS. THE WORKING WIDTH SHALL BE 10 METERS FOR PURPOSES OF FUTURE MAINTENANCE.
 - ALL OWNERS ALONG THE COURSE OF THE DRAIN SHALL MAKE AN ACCESS ROUTE FROM THE NEAREST ROAD TO THE DRAIN LOCATION AVAILABLE TO THE CONTRACTOR. THE AVERAGE WIDTH OF THIS ROUTE SHALL NOT EXCEED 8 METERS. THE ACCESS ROUTE SHALL ALSO APPLY FOR FUTURE MAINTENANCE PURPOSES.
 - CONTRACTOR TO VERIFY EXACT LOCATION AND ELEVATION OF ALL UTILITIES PRIOR TO CONSTRUCTION.
 - ALL TREES, SCRUB, BUSH, ETC. TO BE CLEARED AND GRUBBED IN ACCORDANCE WITH SPECIFICATIONS.
 - QUARRY STONE SHALL RANGE IN SIZE FROM 150mm TO 400mm EVENLY DISTRIBUTED AND SHALL BE PLACED TO A 400mm THICKNESS ON A SUITABLE FILTER BLANKET AT A 1.5 : 1 SLOPE UNLESS OTHERWISE NOTED. FILTER BLANKET TO BE "MIRAFI 140 NC" OR APPROVED EQUAL.
 - CONTRACTOR TO ARRANGE A PRE-CONSTRUCTION MEETING WITH THE ENGINEER, DRAINAGE SUPERINTENDENT, AND THE AFFECTED OWNERS. ALL PARTIES SHALL RECEIVE 48 HOURS NOTICE TO THE MEETING.
 - ALL CONCRETE TILE TO BE A.S.T.M. C 412 EXTRA-QUALITY PLUS 25% UNLESS OTHERWISE NOTED.
 - EXACT LOCATION AND ELEVATIONS OF NEW CATCH BASINS TO BE CONFIRMED BY ENGINEER OR DRAINAGE SUPERINTENDENT.
 - CATCHBASINS TO HAVE "BIRD CAGE" TYPE GRATES WHICH ARE TO BE SECURED WITH NON-CORROSIVE FASTENERS.
 - CONSTRUCT COMPACTED & SEEDED CLAY BERMS BEHIND ALL DITCH INLET CATCHBASINS. BERMS TO BE KEPT 300mm INTO UNDISTURBED SOIL.
 - ROAD DITCHES TO BE GRADED TO NEW CATCHBASINS FOR 15m EACH WAY OF NEW CATCHBASINS AND SEEDED.
 - THE UPPER PORTION OF ALL STANDARD CATCHBASINS SHALL CONSIST OF TWO 150mm RISER SECTIONS.
 - THERE SHALL BE ONE 150mm RISER SECTION BETWEEN THE SLOPE TOP RISER AND THE BASE OF ALL DITCH INLET CATCHBASINS ON ROAD PROPERTY.
 - EXACT LOCATION OF NEW TILE DRAINS TO BE CONFIRMED BY DRAINAGE SUPERINTENDENT OR ENGINEER PRIOR TO CONSTRUCTION.
 - TRENCH BOTTOM FOR CONCRETE TILE SHALL BE SHAPED TO CONFORM TO THE OUTSIDE DIAMETER OF THE PIPE FOR A MINIMUM WIDTH OF ONE-HALF OF THE OUTSIDE DIAMETER.
 - THE MINIMUM TRENCH WIDTH SHALL BE EQUAL TO THE OUTSIDE DIAMETER OF THE TILE TO BE INSTALLED PLUS 100mm (4") ON EACH SIDE UNLESS OTHERWISE APPROVED.
 - THE MAXIMUM TRENCH WIDTH SHALL BE EQUAL TO THE OUTSIDE DIAMETER OF THE TILE TO BE INSTALLED PLUS 250mm (10") ON EACH SIDE. WIDER MAXIMUM TRENCH WIDTHS MUST BE APPROVED BY THE ENGINEER PRIOR TO CONSTRUCTION.
 - NO TILE SHALL BE BACKFILLED UNTIL INSPECTED BY THE ENGINEER OR DRAINAGE SUPERINTENDENT UNLESS OTHERWISE APPROVED BY THE ENGINEER.
 - ALL JOINTS BETWEEN CONCRETE TILES, AND CONCRETE TILE & VARIOUS PIPES, ARE TO BE SECURELY AND COMPLETELY WRAPPED WITH GEOTEXTILE SUCH AS "MIRAFI 140 NL" OR EQUIVALENT. THE GEOTEXTILE SHALL BE 300mm WIDE FOR TILE SIZES OF 150mm TO 300mm AND 400mm WIDE FOR TILE SIZES OF 350mm TO 1500mm. ENDS OF THE WRAP AT EACH JOINT SHALL OVERLAP A MINIMUM OF 150mm.

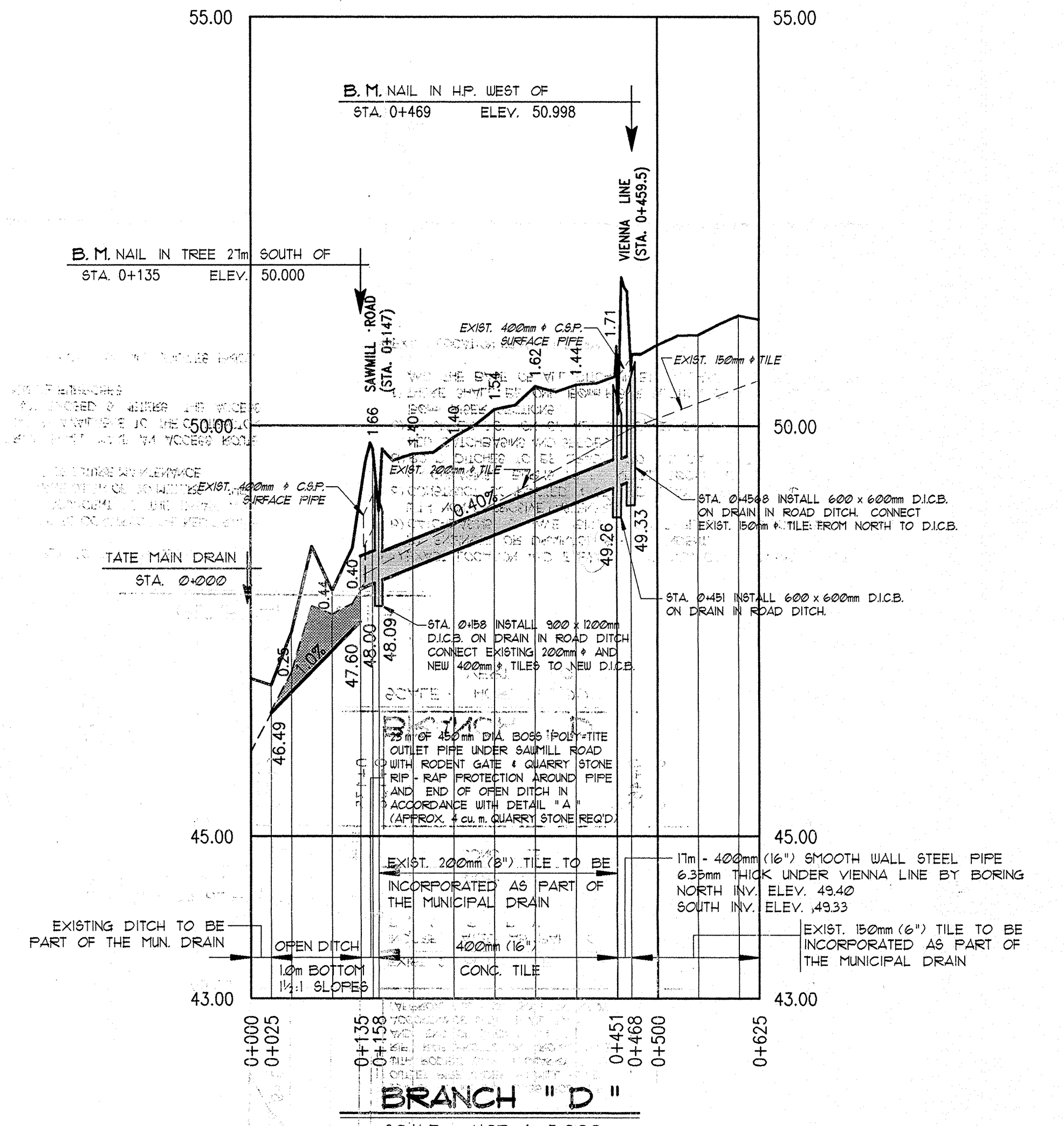
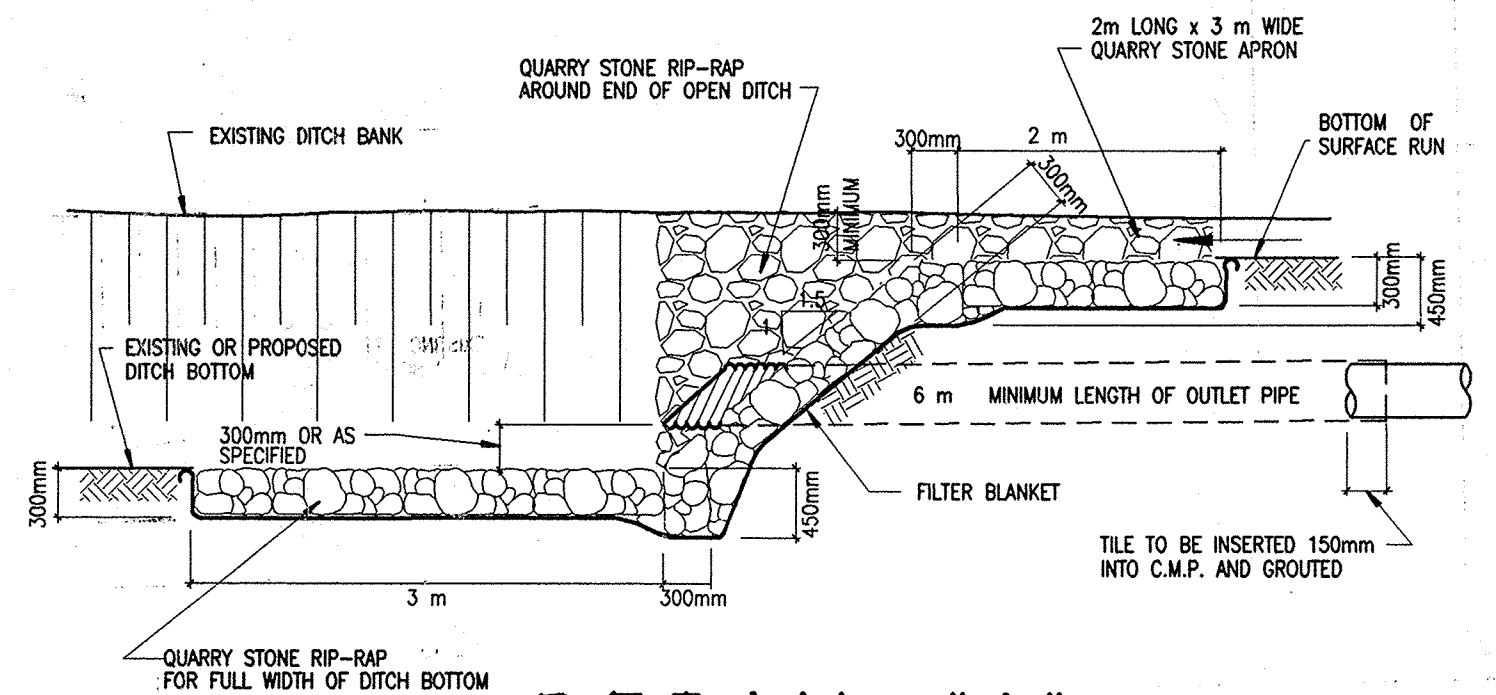

Drainage Superintendent: DON WEIR (Tel. 519-773-5344)

BRANCH "D" - TATE DRAIN
TOWNSHIP OF MALAHIDE

Drawn By: J.N.H.	Field Book	JOB No.	Drawing No.
Date: JUNE 11, 1999	B-128	98211	1 of 1

PLAN & PROFILE

SPRIET ASSOCIATES
LONDON CONSULTING ENGINEERS LIMITED

155 YORK STREET - LONDON (519) 672-4100 - N6A 1A8