

PLAN SCALE 1 : 1,500

**PLAN LEGEND**

|  |  |
|--|--|
|  | LIMIT OF WATERSHED AREA  |
|  | PROPOSED DRAINAGE WORKS  |
|  | EXTERIOR OR INTERIOR WATERSHED   |
|  | EXIST. PRINCIPAL DRAIN   |
|  | PRIVATE TILE OR SURFACE WATER RUN  |
|  | EXIST. WATERCOURSE OR PRIVATE DITCH  |
|  | 10 - 0.25<br>1:1,000<br>40 - 0.5 ha.<br>ASSESSMENT ROLL NUMBER<br>OWNER'S NAME<br>HECTARES OWNED |
|  | BUSH AREA  |
|  | AREA TILED EAST<br>SURFACE WATER TO TATE DRAIN   |

REVISED : FOR TENDERS JANUARY 15, 2003  
 Drainage Superintendent: DON WEIR (Tel. 513-713-5344)

**TATE DRAIN 2002**  
 TOWNSHIP OF MALAHIDE

|                     |                   |                 |                     |
|---------------------|-------------------|-----------------|---------------------|
| Drawn By: J. N. H.  | Field Book: T. S. | JOB No.: 202161 | Drawing No.: 1 of 2 |
| Date: NOV. 29, 2002 |                   |                 |                     |

PLAN

**SPRIET ASSOCIATES LIMITED**  
 CONSULTING ENGINEERS  
 155 YORK STREET - LONDON (519) 672-4100 - 4100-118A 1A8

CONCESSION 2

CONCESSION 1

011-111-10  
J. WHITE  
0.291 ha.

011-111-00  
H. ZIMMER  
31.08 ha.

011-112-00  
G. UNDERHILL  
23.88 ha.

011-034-00  
D. & L. FASHMORE  
194.25 ha.

011-039-00  
R/K HAYHOE INC.  
35.61 ha.

SAWMILL ROAD

LOT 26

( COUNTY ROAD NO. 42 )

NOVA SCOTIA LINE

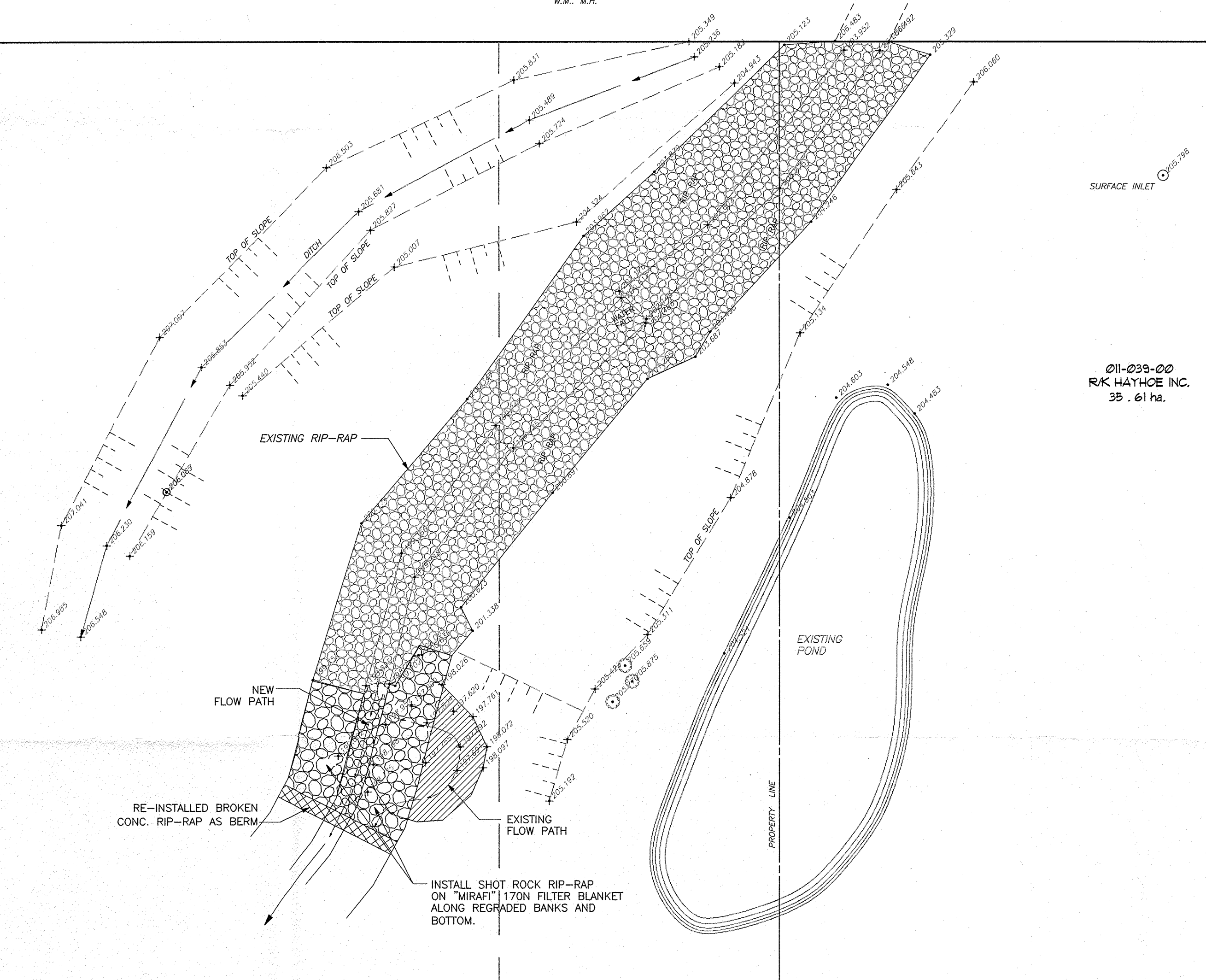
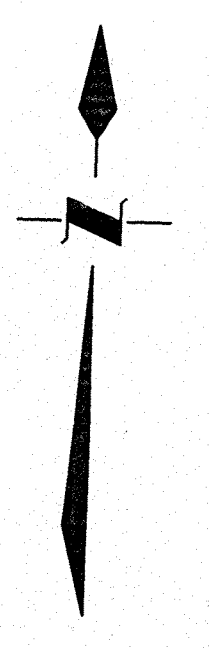

- CONSTRUCTION NOTES**
1. REMOVE FALLEN TREES FROM WATERWAY AND PILE TO SIDE.
  2. MOVE EXIST. BROKEN CONCRETE RIP-RAP AND RE-INSTALL AS BERM AT DOWNSTREAM END OF SHOT ROCK RIP-RAP
  3. RE-GRADE DITCH BANKS AND RE-ESTABLISH EAST BANK ALONG AREA OF WASHOUT WITH ON-SITE CLAY.
  4. INSTALL SHOT ROCK RIP-RAP ON "MIRAFI" 170N FILTER BLANKET OR APPROVED EQUAL ALONG REGRADED BANKS AND BOTTOM.
  5. ALL DISTURBED AREAS NOT COVERED BY RIP-RAP TO BE SEEDED WITH THE FOLLOWING BANK STABILIZING SEED MIXTURE AT RATE OF 85kg/Ha:  
 PICKSEED CO.  
 10% WHITE CLOVER  
 15% FIESTA PERENNIAL RYEGRASS  
 25% TALL FESCUE  
 15% CREEPING RED FESCUE  
 10% CHEWINGS FESCUE  
 15% TIMOTHY  
 10% DORMIE KENTUCKY BLUEGRASS

PLAN SCALE 1: 250

**GENERAL NOTES**

- 1) OUR SPECIFICATIONS DATED NOVEMBER 2000 APPLY TO THIS PROJECT.
- 2) ACCESS ROUTE SHALL BE THROUGH EITHER PROPERTY ROLL No. 11-069 & 11-034 OWNERS ALONG THE DRAIN SHALL MAKE AN ACCESS ROUTE FROM THE NEAREST ROAD TO THE DRAIN LOCATION AVAILABLE TO THE CONTRACTOR. THE AVERAGE WIDTH OF THIS ROUTE SHALL NOT EXCEED 8 METERS. THE ACCESS ROUTE SHALL ALSO APPLY FOR FUTURE MAINTENANCE PURPOSES.
- 3) RIP-RAP TO BE SHOT ROCK AND RANGE IN SIZE FROM 150mm TO 600mm PLACED TO A DEPTH OF 450mm THICKNESS ON A FILTER BLANKET WHICH IS TO BE MIRAFI 170N OR APPROVED EQUAL. (APPROX. 120 TONNES OF ROCK REQ'D)

REVISED: FOR TENDERS JANUARY 15, 2003  
Drainage Superintendent: DON WEIR (Tel. 519-773-5344)

**TATE DRAIN 2002**  
TOWNSHIP OF MALAHIDE

|  |                     |            |         |             |
|--|---------------------|------------|---------|-------------|
|  | Drawn By: PM        | Field Book | JOB No. | Drawing No. |
|  | Date: NOV. 29, 2002 | T.S.       | 202161  | 2 of 2      |
| DETAIL PLAN  |                     |            |         |             |
| <b>SPRIET ASSOCIATES</b><br>LONDON CONSULTING ENGINEERS LIMITED<br><small>155 YORK STREET --LONDON (519) 672-4100--M6A 1A8</small> |                     |            |         |             |