

MARSHALL MUNICIPAL DRAIN

TOWNSHIP OF MALAHIDE LOTS 20-25 CON. IV

SCALE
 PLAN 1" = 600'
 PROFILE 1" = 4'
 VERTICAL 1" = 4'
 HORIZONTAL 1" = 200'

JOB NO. T2032 JANUARY 29, 1971

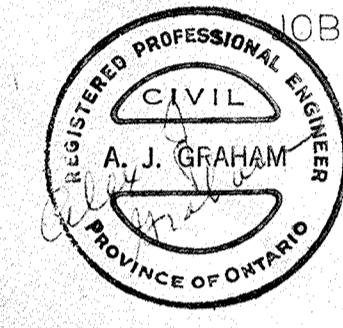

GRAHAM, BERMAN & ASSOC. LTD.
 CONSULTING ENGINEERS
 ST. THOMAS, ONTARIO

1	D. DYCK	375
2	M. LAUR	120
3	E. DREYER	125
4	B. STRICKLAND	125

APPROXIMATE CUTS FROM GROUND LINE TO DESIGN GRADE

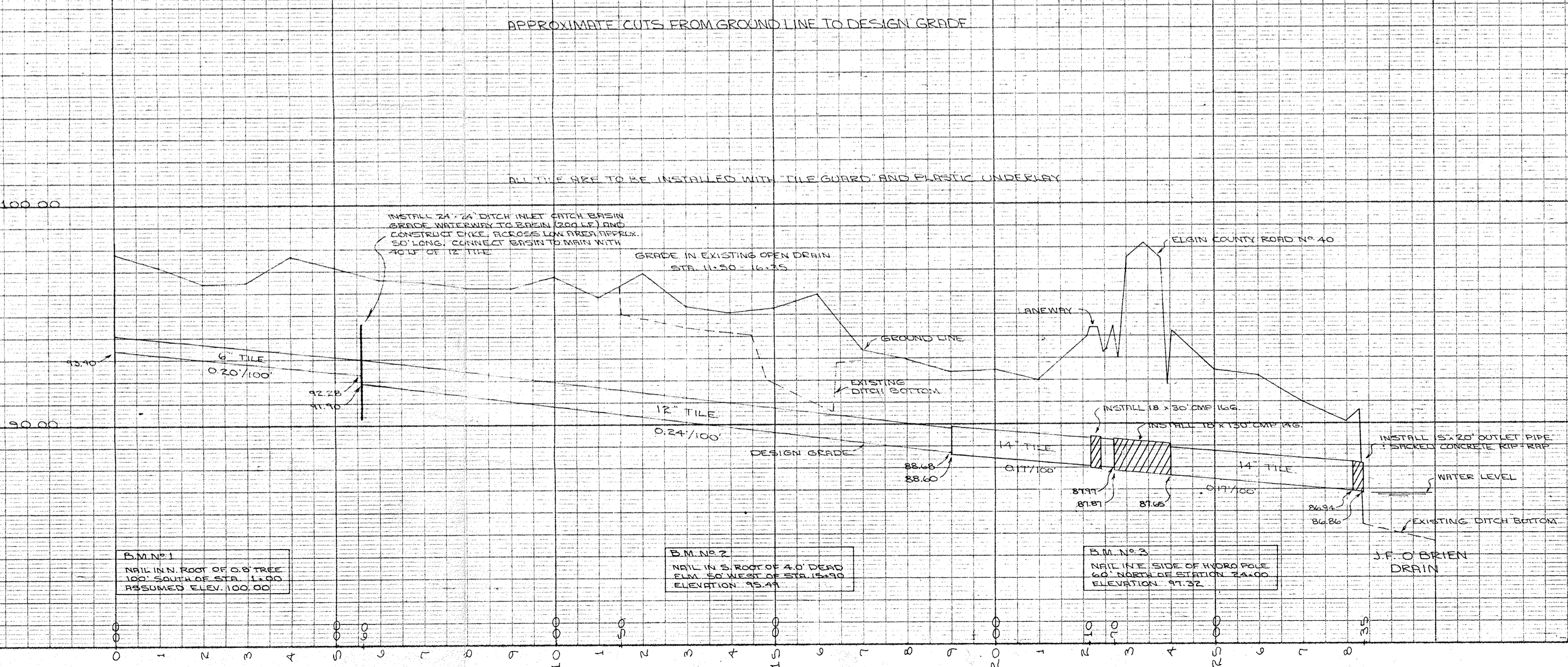

B.M. No. 1
 NAIL IN N. ROOT OF O.B. TREE
 100' SOUTH OF STA. 1+00
 ASSUMED ELEV. 100.00

B.M. No. 2
 NAIL IN S. ROOT OF 4.0' DEAD
 ELM. 50' WEST OF STA. 15+30
 ELEVATION 95.41

B.M. No. 3
 NAIL IN E. SIDE OF HYDRO POLE
 60' NORTH OF STATION 24+00
 ELEVATION 91.32