

GRASSED WATERWAY CONSTRUCTION

- EXISTING EROSION TO BE BACKFILLED USING ON-SITE FILL MATERIAL. TOP-SOIL TO BE STRIPPED FROM CONSTRUCTION AREA AND STOCKPILED PRIOR TO BACKFILLING WASHOUT AND CONSTRUCTION OF WATERWAY.
- WATERWAY TO BE LOCATED ON THE WEST SIDE OF NEW TILE DRAIN. WATERWAY TO BE PARABOLIC IN SHAPE WITH A WIDTH OF 10m AND AN AVERAGE DEPTH OF 300mm. (SEE DETAIL 'B')
- TOPSOIL TO BE RELEVELLED OVER THE WATERWAY AND OTHER AREAS DISTURBED BY CONSTRUCTION.
- WATERWAY TO BE PREPARED FOR SEEDING BY HARROWING AND THEN SEEDING BY DRILLING FOLLOWED BY PACKING OR ROLLING. SEEDING RATE TO BE 25 Kg/ha WITH THE FOLLOWING MIXTURE:
 - 30% CANON CANADA BLUEGRASS
 - 25% KOKET CHEWINGS FESCUE
 - 30% REBEL TALL FESCUE
 - 15% DIPLOMAT PERENNIAL RYE
 PLUS #15 BIRDSFOOT TREFOIL (25% OF TOTAL WEIGHT)
- EARTH WORK TO BE BY CONTRACTOR AND PAID FOR ON AN HOURLY RATE FOR MACHINE WORK AS QUOTED ON THE FORM OF TENDER. EARTH WORK AND SEEDING ETC. TO BE BY DIRECTION OF DRAINAGE SUPERINTENDENT.

GENERAL NOTES

- OUR SPECIFICATIONS DATED JANUARY 1983 APPLY TO THIS PROJECT.
- THE WORKING WIDTH AVAILABLE TO THE CONTRACTOR TO CONSTRUCT THE NEW DRAINS SHALL CONSIST OF THOSE LANDS IMMEDIATELY ADJACENT TO THE DRAIN AND CONNECTIONS AND SHALL NOT EXCEED AN AVERAGE WIDTH OF 20 METERS. THE WORKING WIDTH SHALL BE 10 METERS FOR PURPOSES OF FUTURE MAINTENANCE.
- ALL OWNERS ALONG THE COURSE OF THE DRAIN SHALL MAKE AN ACCESS ROUTE FROM THE NEAREST ROAD TO THE DRAIN LOCATION AVAILABLE TO THE CONTRACTOR. THE AVERAGE WIDTH OF THIS ROUTE SHALL NOT EXCEED 8 METERS. THE ACCESS ROUTE SHALL ALSO APPLY FOR FUTURE MAINTENANCE PURPOSES.
- CONTRACTOR TO VERIFY EXACT LOCATION AND ELEVATION OF ALL UTILITIES PRIOR TO CONSTRUCTION.
- ALL TREES, SCRUB, BRUSH, ETC. TO BE CLEARED AND GRUBBED IN ACCORDANCE WITH SPECIFICATIONS.
- QUARRY STONE SHALL RANGE IN SIZE FROM 150mm TO 400mm EVENLY DISTRIBUTED AND SHALL BE PLACED TO A 400mm THICKNESS ON A SUITABLE FILTER BLANKET AT A 1.5 : 1 SLOPE UNLESS OTHERWISE NOTED. FILTER BLANKET TO BE "MIRAFI 140 NC" OR APPROVED EQUAL.
- CONTRACTOR TO ARRANGE A PRE-CONSTRUCTION MEETING WITH THE ENGINEER, DRAINAGE SUPERINTENDENT, AND THE AFFECTED OWNERS. ALL PARTIES SHALL RECEIVE 48 HOURS NOTICE TO THE MEETING.
- ALL CONCRETE TILE TO BE A.G.T.M. C 412 EXTRA-QUALITY PLUS 25% UNLESS OTHERWISE NOTED.
- EXACT LOCATION AND ELEVATIONS OF NEW CATCH BASINS TO BE CONFIRMED BY ENGINEER OR DRAINAGE SUPERINTENDENT.
 - CATCHBASINS TO HAVE "BIRD CAGE" TYPE GRATES WHICH ARE TO BE SECURED WITH NON-CORROSIVE FASTENERS.
 - CONSTRUCT COMPACTED & SEEDED CLAY BERM'S BEHIND ALL DITCH INLET CATCHBASINS. BERM'S TO BE KEYED 300mm INTO UNDISTURBED SOIL.
 - ROAD DITCHES TO BE GRADED TO NEW CATCHBASINS FOR 5m EACH WAY OF NEW CATCHBASINS AND SEEDED.
 - THE UPPER PORTION OF ALL STANDARD CATCHBASINS SHALL CONSIST OF TWO 150mm RISER SECTIONS.
 - THERE SHALL BE ONE 150mm RISER SECTION BETWEEN THE SLOPE TOP RISER AND THE BASE OF ALL DITCH INLET CATCHBASINS ON ROAD PROPERTY.
- EXACT LOCATION OF NEW TILE DRAINS TO BE CONFIRMED BY DRAINAGE SUPERINTENDENT OR ENGINEER PRIOR TO CONSTRUCTION.
 - TRENCH BOTTOM FOR CONCRETE TILE SHALL BE SHAPED TO CONFORM TO THE OUTSIDE DIAMETER OF THE PIPE FOR A MINIMUM WIDTH OF ONE-HALF OF THE OUTSIDE DIAMETER.
 - THE MINIMUM TRENCH WIDTH SHALL BE EQUAL TO THE OUTSIDE DIAMETER OF THE TILE TO BE INSTALLED PLUS 100mm (4") ON EACH SIDE UNLESS OTHERWISE APPROVED.
 - THE MAXIMUM TRENCH WIDTH SHALL BE EQUAL TO THE OUTSIDE DIAMETER OF THE TILE TO BE INSTALLED PLUS 250mm (10") ON EACH SIDE. WIDER MAXIMUM TRENCH WIDTHS MUST BE APPROVED BY THE ENGINEER PRIOR TO CONSTRUCTION.
 - NO TILE SHALL BE BACKFILLED UNTIL INSPECTED BY THE ENGINEER OR DRAINAGE SUPERINTENDENT UNLESS OTHERWISE APPROVED BY THE ENGINEER.

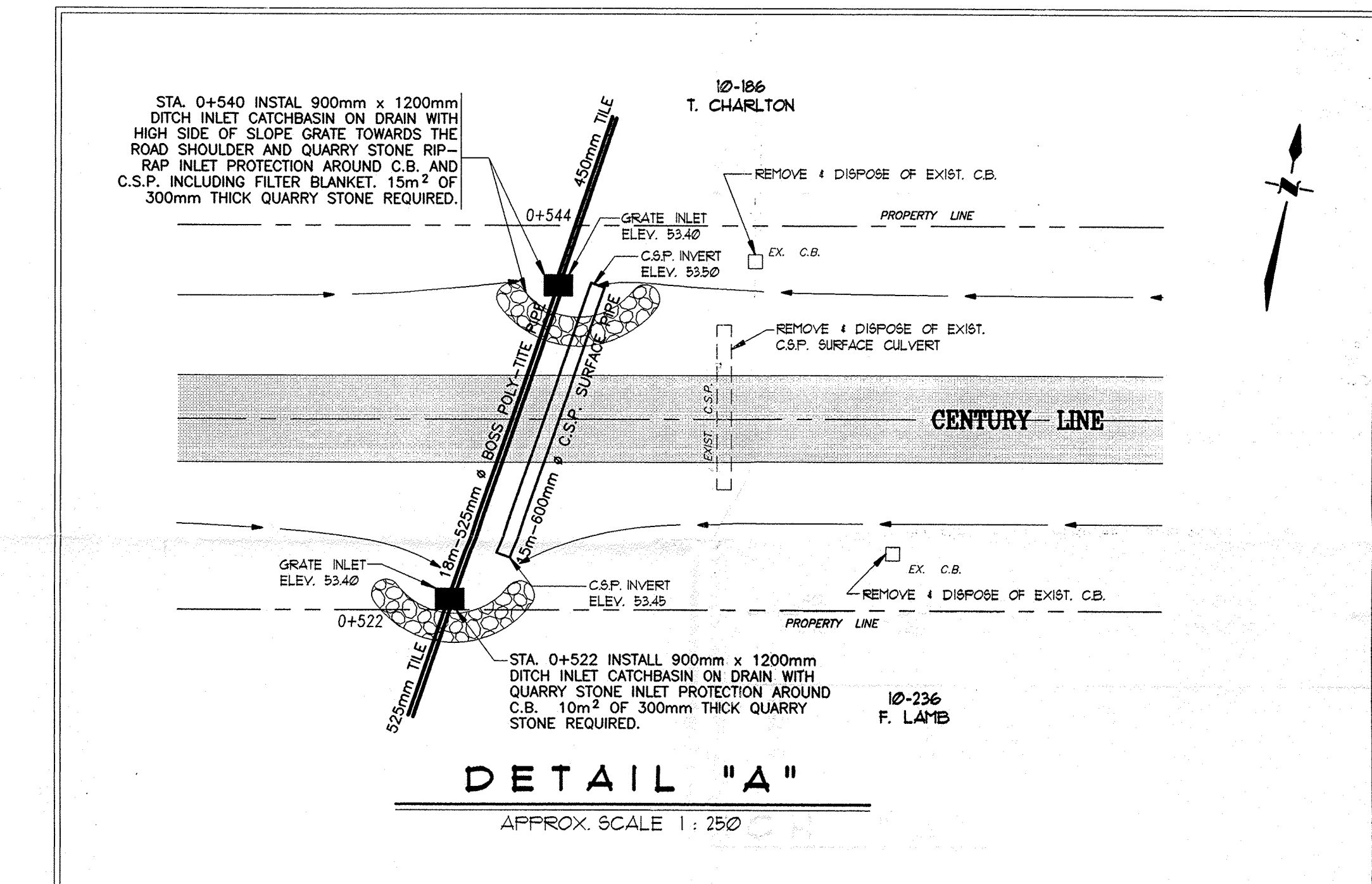
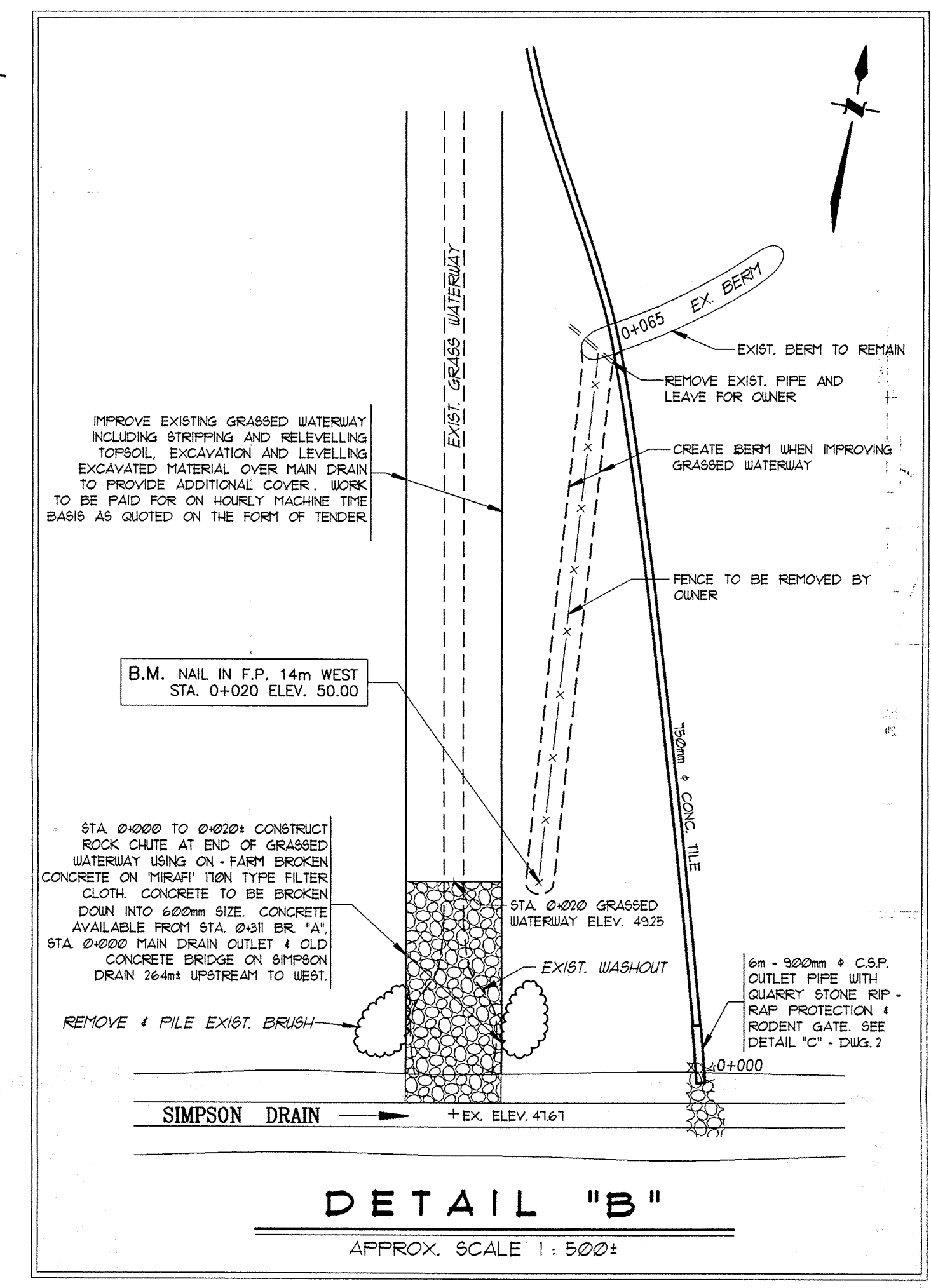

Drainage Superintendent: DON WEIR (Tel. 519- 773-5344)

LAMB DRAIN
TOWNSHIP OF MALAHIDE

Drawn By: J. N. H.	Field Book	JOB No.	Drawing No.
Date: MAR 23, 1998	B - 125	97108	1 of 2

PLAN & PROFILE

SPRIET ASSOCIATES
LONDON CONSULTING ENGINEERS LIMITED
155 YORK STREET - LONDON (519) 672-4100 - N6A 1A8

REGISTERED PROFESSIONAL ENGINEER
J. R. SPRIET
PROVINCE OF ONTARIO