

PLAN SCALE 1:10000

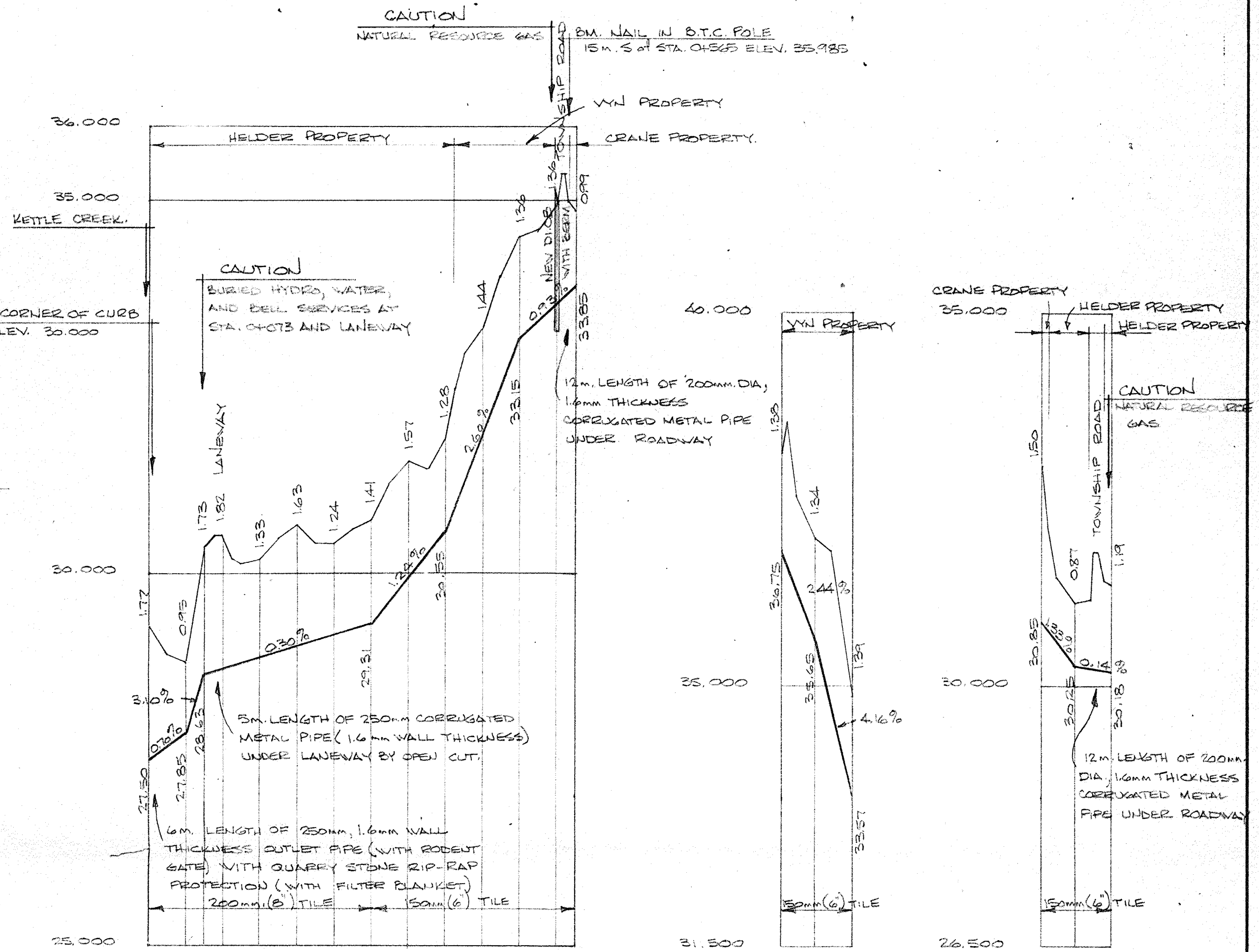

MAIN DRAIN PROFILE BRANCH "A" BRANCH "B"

- GENERAL NOTES**
- 1) OUR SPECIFICATIONS DATED JANUARY 1983 APPLY TO THIS PROJECT.
 - 2) THE WORKING WIDTH AVAILABLE TO THE CONTRACTOR TO CONSTRUCT THE DRAIN SHALL CONSIST OF THOSE LANDS IMMEDIATELY ADJACENT TO THE DRAIN AND CONNECTIONS AND SHALL NOT EXCEED AN AVERAGE WIDTH OF 15 METERS.
 - 3) ALL OWNERS ALONG THE COURSE OF THE DRAIN SHALL MAKE AN ACCESS ROUTE FROM THE NEAREST ROAD TO THE DRAIN LOCATION AVAILABLE TO THE CONTRACTOR. THE AVERAGE WIDTH OF THIS ROUTE SHALL NOT EXCEED 8 METERS.
 - 4) CONTRACTOR TO VERIFY EXACT LOCATION AND ELEVATION OF ALL UTILITIES PRIOR TO CONSTRUCTION.
 - 5) CONTRACTOR TO CONTACT NATURAL RESOURCE GAS COMPANY PRIOR TO START OF CONSTRUCTION FOR LOCATION AND ELEVATIONS.
 - 6) EXACT LOCATION OF NEW TILE DRAIN TO BE CONFIRMED BY ENGINEER OR DRAINAGE SUPERINTENDENT AT TIME OF CONSTRUCTION.
 - 7) a) EXACT LOCATION AND ELEVATIONS OF NEW CATCHBASIN TO BE CONFIRMED BY ENGINEER OR DRAINAGE SUPERINTENDENT.
b) CATCHBASIN TO HAVE "BIRD CAGE" TYPE GRATE.

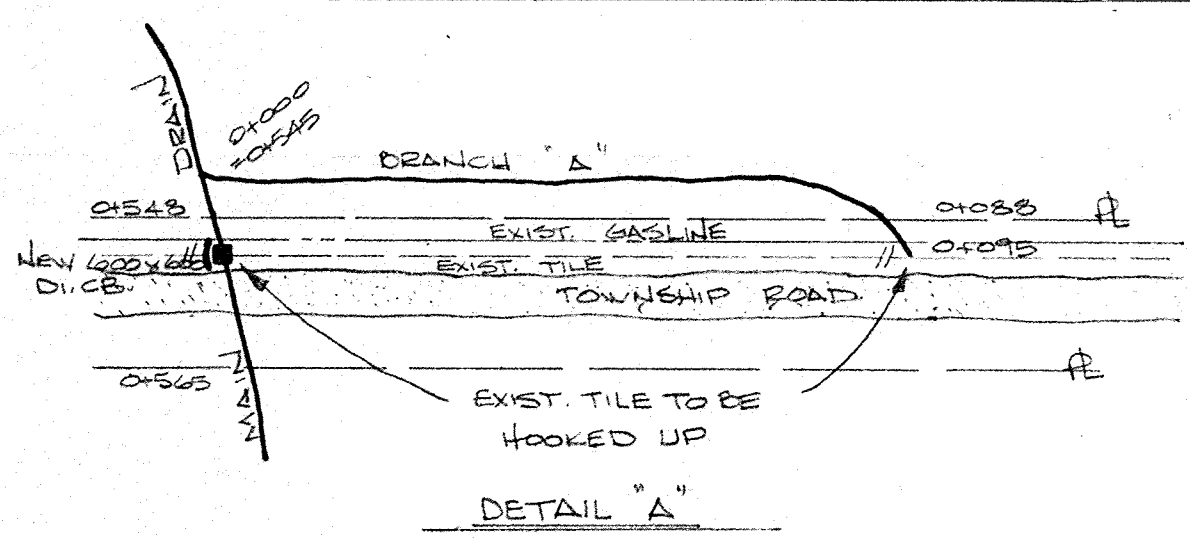

SCALE hor. 1:5000
vert. 1:50

HELDER ROAD DRAIN			
TOWNSHIP OF SOUTH DORCHESTER			
Scale: AS SHOWN	Approved By: FB DIES	JOB NO. 90174	Drawn By: W.R.
Date: MARCH 11 1991			Revised:
PLAN & PROFILE			
SPRIET ASSOCIATES CONSULTING ENGINEERS		LONDON SUDBURY	Drawing Number 1